



FLOODPLAIN NOTE:
 PER FEDERAL EMERGENCY MANAGEMENT AGENCY (FEMA) FLOOD INSURANCE RATE MAP (FIRM) FOR CARROLL COUNTY (ALL JURISDICTIONS), COMMUNITY NUMBER 330014, MAP NUMBERS 33003C0080 AND 33003C0090, EFFECTIVE DATE 3/19/2013, THE SUBJECT PREMISES LIES ENTIRELY WITHIN ZONE X, WHICH IS DEFINED AS THOSE "AREAS DETERMINED TO BE OUTSIDE THE 0.2% ANNUAL CHANCE FLOODPLAIN."

APPROXIMATE DETAIL NOTE:
 SOME ROAD DETAIL SHOWN HEREON WITH LIGHT GRAY LINES IS APPROXIMATE, BASED ON LIDAR DATASET FILES AND PHOTOGRAPHY OBTAINED FROM UNIV. OF NEW HAMPSHIRE'S GRANIT LIDAR DISTRIBUTION WEBSITE:
<https://lidar.unh.edu/map/>

NOTE:
 Horiz. Splice/sect in
 15" Hemlock, 1.5' up
 Elev: 797.45'

NHDOT Disc "231-0190"
 in Concrete Bridge Abutment
 Published Elevation: 758.15'
 VERTICAL DATUM: NAVD 1988

- State-Wide Numerical Soils Legend**
- 22 - COLTON
 - 145 - MONADNOCK, extremely bouldery
 - 169 - SUNAPEE, very stony
 - 199 - DUMPS, barkchips and organic matter
 - 214 - NAUMBURG (poorly drained)
 - 299 - UDORTMENTS, smoothed
 - 400 - UDORTMENTS, sandy or gravelly
 - 613 - CROGHAN
 - 647 - PILLSBURY, very stony
 - 916 - CROGHAN VARIANT (somewhat poorly drained)
 - 945 - SUNAPEE VARIANT (somewhat poorly drained), very stony

Supplemental Symbols
 The five components of the Disturbed Soil Mapping Unit Supplement are as follows:

- Symbol 1: Drainage Class**
- a - Excessively Drained
 - b - Somewhat Excessively Drained
 - c - Well Drained
 - d - Moderately Well Drained
 - e - Somewhat Poorly Drained
 - f - Poorly Drained
 - g - Very Poorly Drained
 - h - Not Determined

- Symbol 2: Parent Material (of naturally formed soil only, if present)**
- a - No natural soil within 60"
 - b - Glaciofluvial Deposits (outwash/terraces of sand or sand and gravel)
 - c - Glacial Till Material (active ice)
 - d - Glaciolacustrine very fine sand and silt deposits (glacial lakes)
 - e - Loamy/sandy over Silt/Clay deposits
 - f - Marine Silt and Clay deposits (ocean waters)
 - g - Alluvial Deposits (floodplains)
 - h - Organic Materials - Fresh water Bogs, etc
 - j - Organic Materials - Tidal Marsh

- Symbol 3: Restrictive/Impervious Layers**
- a - None
 - b - Bouldery surface with more than 15% of the surface covered with boulders
 - c - Mineral restrictive layer(s) are present in the soil profile less than 40 inches below the soil surface such as hard pan, platy structure or clayey texture with consistency of at least firm (i.e. more than 20 newtons). For other examples of soil characteristics that qualify for restrictive layers, see "Soil Manual for Site evaluations in NH" 2nd Ed., (page 3-17, figure 3-14)
 - d - Bedrock in the soil profile: 0-20 inches
 - e - Bedrock in the soil profile: 20-60 inches
 - f - Areas where depth to bedrock is so variable that a single soil type cannot be applied, will be mapped as a complex of soils types
 - g - Subject to Flooding
 - h - Man-made impervious surface including pavement, concrete, or built-up surfaces (i.e. buildings) with no morphological restrictive layer within control section

- Symbol 4: Estimated Ksat* (most limiting layer excluding symbol 3h above)**
- a - High
 - b - Moderate
 - c - Low
 - d - Not determined

*See "Guidelines for Ksat Class Placement" in Chapter 3 of the Soil Survey Manual, USDA

Symbol 5: Hydrologic Soil Group*

- a - Group A
- b - Group B
- c - Group C
- d - Group D
- e - Not determined

*excluding man-made surface impervious/restrictive layers

Certification:

This Site-Specific Soil Map is a representation of a compilation of field data collected during July 7 and 12, 2023 by North Country Soil Services. The Site-Specific Soil Map meets the standards set forth by Site-Specific Soil Mapping Standards for New Hampshire and Vermont, SSSNNE Special Publication No. 3, Version 7.0, July 2021. This map has been prepared to comply with soil mapping requirements of RSA 485-A: 17 and NHDES Env-Mq 1500, Alteration of Terrain.

This map product is within the technical standards of the National Cooperative Soil Survey. It is a special use product, intended for the development of the subject parcels. It was produced by a professional soil scientist, and is not a product of the USDA Natural Resource Conservation Service. There is a report that accompanies this map.

Every Aspect of this plan is based on my best knowledge and opinion thereof as of the date of this mapping.

Date: Gregory W. Howard, Certified Soil Scientist #32

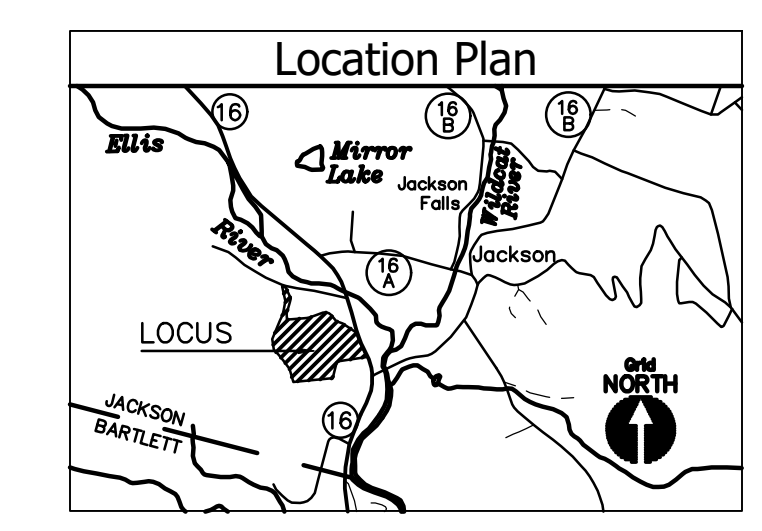

Subject Parcel:

Tax Map Parcel: VO1-5
 Lot 1 (Ref. 5)

Owner of Record: MICHAEL J. MALLET
 PO Box 567
 Jackson, NH 03846

Source Deed: 9/07/2022 3688/556

Tax Map Parcel: VO1-2
 Lot 2 (Ref. 5)

Owner of Record: THE MALLET CORP.
 PO Box 803
 Jackson, NH 03846

Source Deed: 10/16/1997 1721/112

See Also Certificate of Amendment of Jackson Golf & Sleigh Ctr., Inc., now known as The Mallett Corp., at CCD# 2040/322.



SITE-SPECIFIC SOILS MAP

INVOLVING LANDS OF
THE MALLET CORPORATION
 and **MICHAEL J. MALLET**

N.H. Route 16, White Mountain Highway
 Town of Jackson, County of Carroll,
 State of New Hampshire

NO.	DATE	REVISION DESCRIPTION	ENG	DWG

DATE:	PROJECT #:
3/19/2026	250277
SURVD BY:	DRAWN BY:
JAO/TH	KMA/WWS
CHECK'D BY:	

SHEET 1 OF 1